

# St. Paul Ice Fishing & Winter Sports Show

December 4 - 6, 2009

RIVERCENTRE — ST. PAUL, MN

ROY WILKINS

ALL BOOTHS ARE 10' DEEP X 10' WIDE  
(UNLESS MARKED OTHERWISE)  
  
ALL AISLES ARE 10' WIDE  
(UNLESS MARKED OTHERWISE)

EXHIBIT HALL

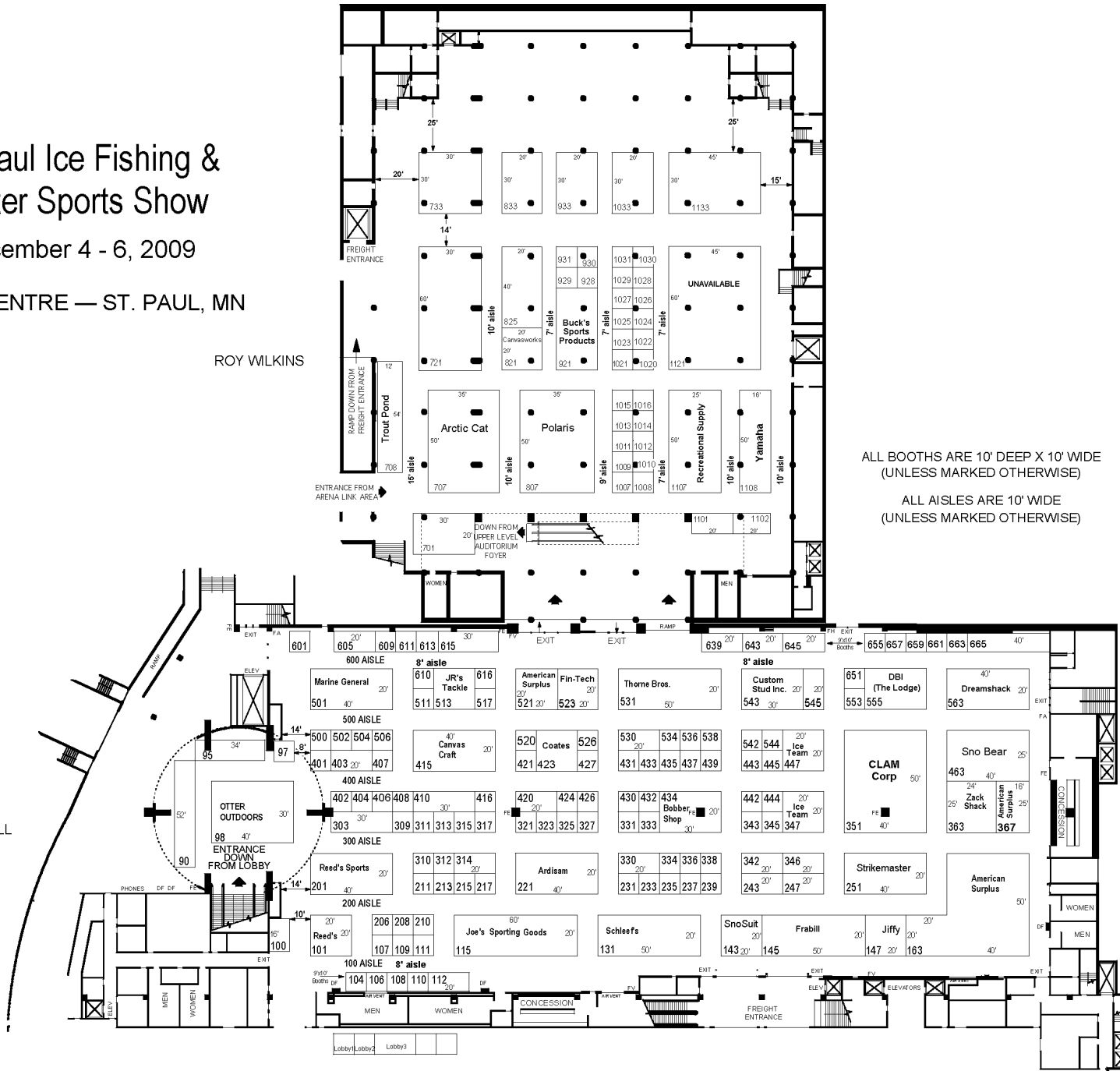

This floor plan is only a preliminary drawing and must be submitted for Fire-Marshall's approval.